

- Fitted with coil transformer resisting unstable voltage.
- Long service life.



VHL-300L



VHL-300M



VHL-300S

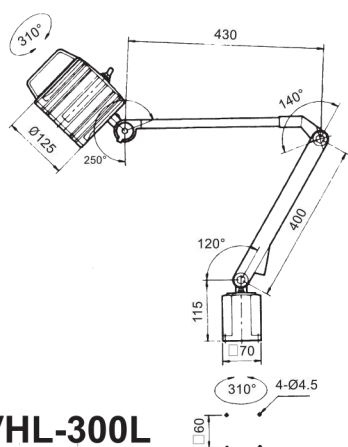

**VHL-300L
LONG ARM**

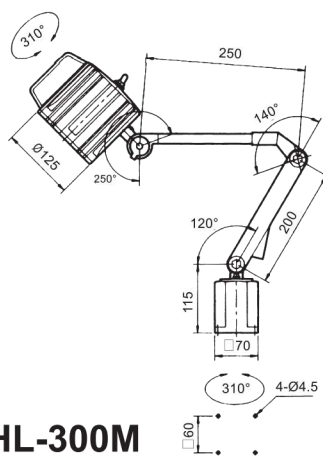

**VHL-300M
MEDIUM ARM**

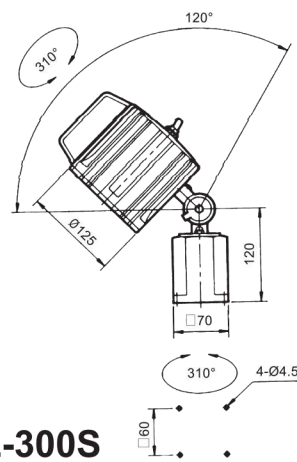

**VHL-300S
SHORT ARM**

• OPTIONAL •

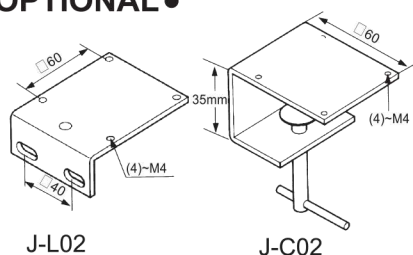

- MOUNTING ANGLE PLATE J-L02
- MOUNTING CLAMP J-C02

Totally enclosed lighting head provides well prevention for explosion, dust, coolant, and lubricants.

Uses efficient quartz halogen bulb, great light output, soft illuminating without irritating to the eyes.

Unit:mm

ORDER NO.	ARM LENGTH L x l	WEIGHT (kg)	CODE NO.
VHL-300L	430X400	3.5	1025-001
VHL-300M	250X200	3.2	1025-002
VHL-300S	1 JOINT	2.4	1025-003
J-L02		0.4	1025-004
J-C02		0.4	1025-005

FEATURES

- Coil transformer built in base for directly connect to voltage of Ac power. (110V, 220V, 380V.....)
- Specify voltage as desired when ordering.
- It accepts bulb 50W.
- Furnished with 1.8 meter cord with plug.

Dustproof Halogen Lamp UNIVERSAL TYPE

- Fitted with coil transformer resisting unstable voltage.
- Long service life. • With Water proof articulated arm.
- Round tube arm provides great lighting angles.



VHL-300LR



VHL-300MR



VHL-300SR



VHL-300 1/2MR

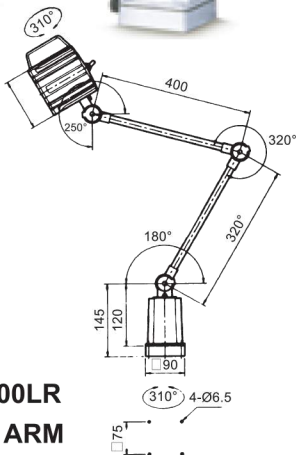

VHL-300LR
LONG ARM

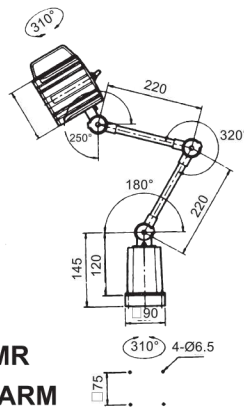

VHL-300MR
MEDIUM ARM

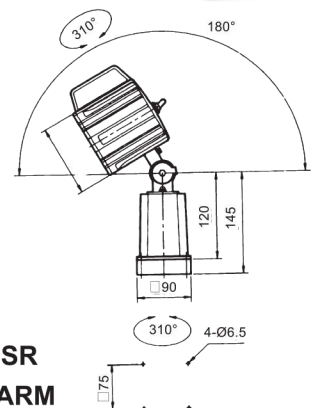

VHL-300SR
SHORT ARM

• OPTIONAL •

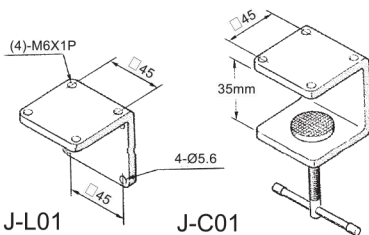

- MOUNTING ANGLE PLATE J-L01
- MOUNTING CLAMP J-C01

Unit:mm

ORDER NO.	ARM LENGTH L x l	WEIGHT (kg)	CODE NO.
VHL-300LR	400X400 (With Water Proof)	4.8	1025-010
VHL-300MR	200X200 (With Water Proof)	4.5	1025-011
VHL-300SR	1 JOINT (With Water Proof)	3.5	1025-012
VHL-300 1/2MR	200 (With Water Proof)	4.3	1025-013
J-L01		0.4	1025-014
J-C01		0.4	1025-015

Totally enclosed lighting head provides well prevention for explosion, dust, coolant, and lubricants.

Uses efficient quartz halogen bulb, great light output, soft illuminating without irritating to the eyes.

FEATURES

- Coil transformer built in base for directly connect to voltage of Ac power. (110V, 220V, 380V.....)
- Specify voltage as desired when ordering.
- It accepts bulb 50W,55W,70W.
- Furnished with 1.8 meter cord with plug.

Quartz Halogen Lamp

- Gooseneck arm for smooth lighting angle adjustment.
- Lighting reaches any direction.

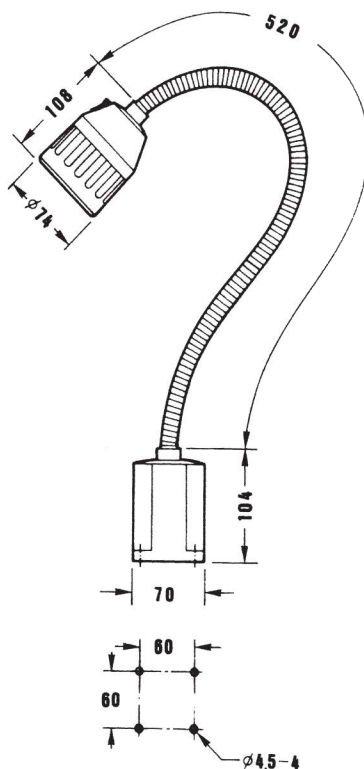

ORDER NO.	WEIGHT (kg)	CODE NO.
VHL-20FT	1.6	1025-020
VHL-20F	1.3	1025-021
J-M01	0.46	1025-006
J-L02	0.4	1025-004
J-C02	0.4	1025-005

• OPTIONAL •

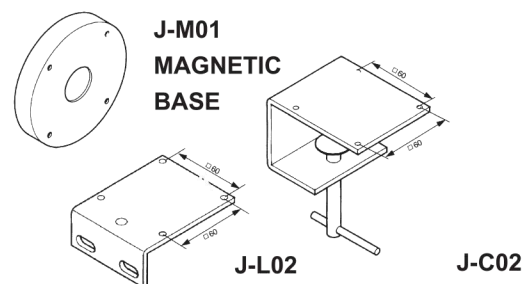

- MOUNTING CLAMP J-C02
- MOUNTING ANGLE PLATE J-L02

VHL-20FT SERIES

- Engineering plastic shade and base provides complete insulation for maximum operator safety.
- Power source available: Any voltage on customer's request. Such as 110V, 220V, 240V, 380V, 415V.
- Transformer built in base.
- Accept 20,35 and 50 watt bulb. Included with 20 watt bulb, 35 and 50 watt bulb on request.
- Furnished with 1.8 meter (70") cord.
- Available with magnetic base.
- Engineering mounting angle plate. (optional)
- Double shades designed permits fast heat dissipation.

VHL-20F SERIES

- The quartz halogen lamp has great light output, soft illuminating without irritating to the eyes.
- Low voltage 12 or 24 volt operation without danger of electric shock.
- The articulated arm provides vibration resistance performance.
- Articulated arm.
- Use top quality electric components.
- Accept 20,35,50 watt bulb. Included with 20 watt bulb, 35 and 50 watt bulb on request.
- Complete with 1.8 meters (70") cord.
- Economical model, jet quality constructed. Ideally suited to machine tools and machinery without big working area.
- Engineering plastic shade and base provides complete insulation.

Cool Light Lamp

WATERPROOF TYPE



D SERIES



DB SERIES



• Outstanding Water-proof Performance

Separate ballast series

ORDER NO.	LAMP LENG	WATT	DIA	WEIGHT (kg)	CODE NO.
VHL-W10D	518m/m	10	70mm	3.2	1025-030
VHL-W15D	632m/m	15	70mm	3	1025-031
VHL-W18D/PL	425m/m	18	70mm	2	1025-032
VHL-W20D	765m/m	20	70mm	3.6	1025-033
VHL-W36D/PL	621m/m	36	70mm	2.9	1025-034
VHL-W40D	1835m/m	40	70mm	3.5	1025-035

Built-in ballast series

ORDER NO.	LAMP LENG	WATT	DIA	WEIGHT (kg)	CODE NO.
VHL-W10DB	611m/m	10	70mm	3.2	1025-040
VHL-W15DB	717m/m	15	70mm	3	1025-041
VHL-W18DB/PL	525m/m	18	70mm	2	1025-042
VHL-W20DB	861m/m	20	70mm	3.6	1025-043
VHL-W36DB/PL	715m/m	36	70mm	2.9	1025-044
VHL-W40DB	1529m/m	40	70mm	3.5	1025-045

FOUR MODELS TO CHOOSE FORM 10, 15, 20, AND 40 WATT. OUTSTANDING FEATURES

- Suited for machine lighting. indoor and outdoor lighting.
- Cool lighting performance.
- Anti-crack lamp.
- Swivelling mounting bracket (opional).
- Accommodates power source 110V or 220V. single voltage only.
- Specify HZ and voltage when ordering.
- The outer tube is manufactured from acrvlic. When requested. the glass outer tube is available.
- Furnished with 1.8 meter (70") cord.

OPTIONAL

ORDER NO.	WEIGHT(kg)	CODE NO.
JF-110	0.3	1025-050
JF-111	0.3	1025-051
JF-112	0.3	1025-052
JF-115	0.1	1025-053

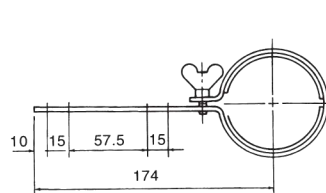

• JF-110
MOUNTING FIXTURE

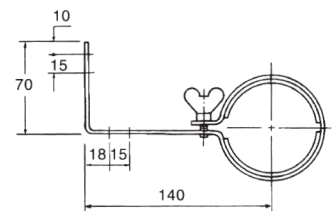

• JF-111
MOUNTING FIXTURE

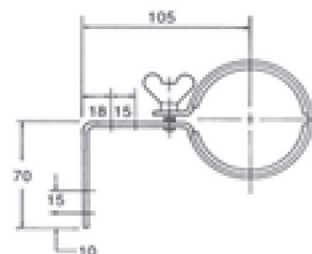

• JF-112
MOUNTING FIXTURE

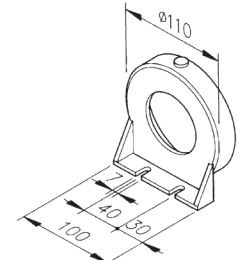

• JF-115
MOUNTING STAND



**VHL-30TEB
BENCH TYPE**



**VHL-30TEBII
BENCH TYPE**



VHL-30MEB



VHL-30LEB

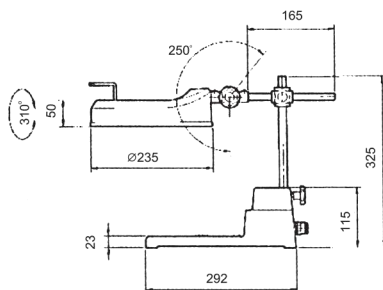

VHL-30TEB VHL-30TEBII BENCH TYPE

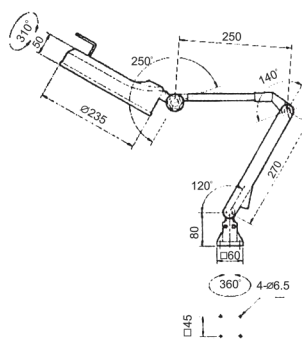

VHL-30MEB MEDIUM ARM

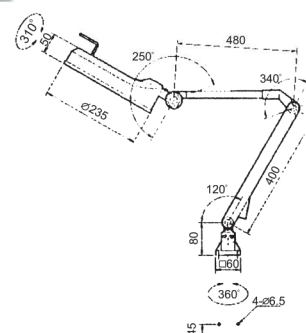

VHL-30LEB LONG ARM

● **OPTION**

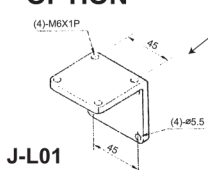

J-L01
● MOUNTING ANGLE
PLATE

● **STANDARD**

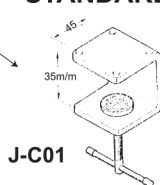

J-C01
● MOUNTING CLAMP

● **OPTIONAL**

ORDER NO. VHL-3X
3X magnifier lens

ORDER NO.	WEIGHT (kg)	CODE NO.
VHL-30TEB	4	1025-060
VHL-30TEBII	4	1025-061
VHL-30MEB	3.5	1025-062
VHL-30LEB	3.5	1025-063
J-L01	0.4	1025-014
VHL-3X	0.4	1025-065

* All work lights are with 3X magnifier lens, If you need 6 times, you have to choose VHL-3X extraly.

VHL-30TEB

- Bench type model.
- Constructed with a wide base for placing object, allowing it especially suited for inspection lighting.
- Electronic ballast is built in arm.
- Accepts 22 watt fluorescent tube.
- 110V, or 220V operation. Supplied single voltage only. Specify desired voltage when ordering.
- Furnished with 1.8 meter cord with plug. Extended cord length is available when required.

VHL-30TEBII

- Same as mode VHL-30TEB, but except with acrylic board on base for lighting through requirement.

VHL-30 MEB

- Medium arm model.
- Electronic ballast is built in arm.
- Accepts 22 watt fluorescent tube.
- 110V, or 220V operation. Supplied single voltage only. Specify desired voltage when ordering.
- Furnished with 1.8 meter cord with plug. Extended cord length is available when required.

VHL-30 LEB

- Long arm model.
- Electronic ballast is built in arm.
- Accepts 22 watt fluorescent tube.
- 110V, or 220V operation. Supplied single voltage only. Specify desired voltage when ordering.
- Furnished with 1.8 meter cord with plug. Extended cord length is available when required.

Designed with a magnifier lens on luminaire head giving 3 times of magnification 3x than actual object.

The fluorescent lighting provides day light effect without flash.

Water-Proof Halogen Lighting Lamp



400 SERIES

VHL-400L



500 SERIES

VHL-500S



VHL-500L

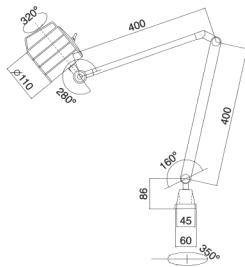

VHL-400L

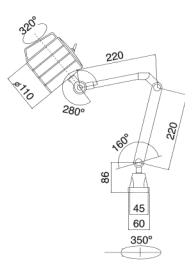

VHL-400M

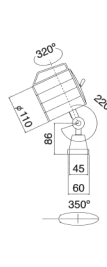

VHL-400S

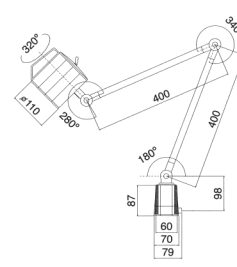

VHL-500L

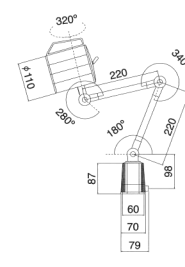

VHL-500M

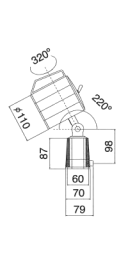

VHL-500S

OPTIONAL



V-20

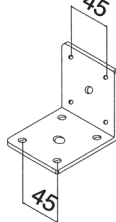

V-21

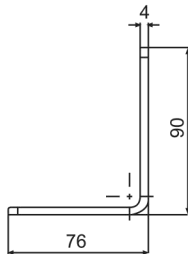

V-26

WATER-PROOF HALOGEN LIGHTING LAMP (VHL-400L SERIES)

LIGHTING HEADS OF THESE SERIES WITH SPECIFIC FEATURES OF WATER-PROOF, DUST-FREE, ANTI-LUBRICAT, ANIT-CUTTING OIL, ETC. THE LIGHTING UNITS ADPOTED WITH A BULB (24V/55W). CUSTOMERS' SPECIFICATIONS ALSO ACCEPTED.

ORDER NO.	CODE NO.
V-20	1025-106
V-21	1025-107
V-26	1025-108

ORDER NO.	VOLTS	BULB	ARM LENGTH L x l	OPTIONAL ACCESSORIES	WEIGHT (N.W.)	CODE NO.
VHL-400L	12V 55W - 24V 70W	12V 55W - 24V 70W	400X400	V-20 / V-21	2.45	1025-100
VHL-400M	12V 55W - 24V 70W	12V 55W - 24V 70W	220X220	V-20 / V-21	2.17	1025-101
VHL-400S	12V 55W - 24V 70W	12V 55W - 24V 70W		V-20 / V-21	1.33	1025-102
VHL-500L	12V 55W - 24V 70W	12V 55W - 24V 70W	400X400	V-20 / V-21	2.85	1025-103
VHL-500M	12V 55W - 24V 70W	12V 55W - 24V 70W	220X220	V-20 / V-21	2.33	1025-104
VHL-500S	12V 55W - 24V 70W	12V 55W - 24V 70W		V-20 / V-21	1.44	1025-105

VHL-400L

- Water-proof lighting head with reinforced glass resists big temperature fluctuations of cutting oil.
- 12V/24V Voltage.
- Flexible Arm (round arm), 420x420mm
- With universal Lighting Base.
- Specifications of Bulb: 24V/70W.
- Different conditions demand different lighting bases. Selected rectangular L-type (#V-20) base or C-type (#V-21) base.

VHL-400M

- Performance & features: same as , but with shorter flexible arm at 220x185mm.

VHL-400S

- Specially designed to fit particular locations and spaces, The flexible arm is very short.

VHL-500L

- Performance & features of these series: same as . The main difference is that VHL-500L can be installed with a shorter arm, and connected with AC current below 240V.
- Please indicate the required voltage when placing the orders to us.
- Specifications of the bulb: 12V/50W

VHL-500M

- Same specifications as VHL-500L, but with shorter flexible arm at 220x220mm.

VHL-500S

- Specially designed to fit particular locations and spaces. The flexible arm is very short.

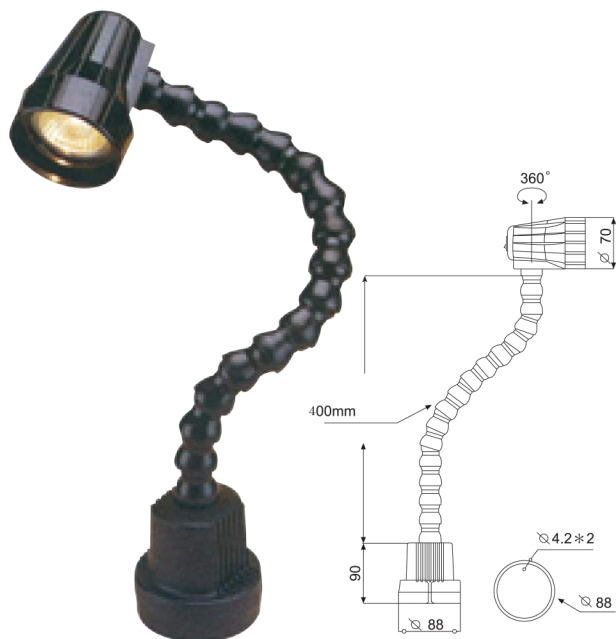

VHL-600FT



VHL-700FT

FEATURES

- VHL-600FT, VHL-700FT type ideal for work-place lighting if bright concentrated light is required in performance not too large area illumination. It is with transformer.
- Suitable for use at small machine such as CNC engraving machine, sewing machine, lathe machine, working benches and working table.....etc.
- VHL-700FT with flexible arm.

ORDER NO.	VOLTS	BULB	ARM LENGTH L x l	OPTIONAL ACCESSORIES	WEIGHT (N.W.)	CODE NO.
VHL-600FT	110V - 220V	12V 20W	400	M-23	1.9	1025-109
VHL-700FT	110V - 220V	12V 20W	400	M-23	1.8	1025-110

V-B15		12V 50W / 24V 50W			0.009	1025-111
V-B16		12V 55W / 24V 70W			0.009	1025-112
V-T17	415V - 12 / 415V - 24 380V - 12 / 380V - 24 230V - 12 / 230V - 24				1.47	1025-113
V-T18	415V - 12 / 415V - 24 380V - 12 / 380V - 24 230V - 12 / 230V - 24				1.4	1025-114
M23						1025-115

V-T17



TRADITIONAL
TRANSFORMER V-T17
SUITABLE FOR
VHL-400 SERIES
VHL-500 SERIES

V-T18



EXTERIOR DUST-FREE
TRANSFORMER
V-T18 Voltage below
415V. Can be installed
anywhere.
Dust-Free, leakage-proof
and oil-proof.

V-B15



V-B15
12V/70W,
24V/50W, 12V/50W
Those bulb for VHL-400,
VHL-500 series

V-B16



V-B16
24V/70W, 12V/55W
Those bulb for VHL-400,
VHL-500 series